

NOTES

1. DO NOT SCALE FROM THIS DRAWING.
2. THIS DRAWING SHALL BE READ IN CONJUNCTION WITH THE OTHER DRAWINGS INCLUDED IN THIS SERIES.
3. LOCATION OF ALL BURIED SERVICES TO BE CONFIRMED PRIOR TO CONSTRUCTION.
3. ALL DIMENSIONS ARE IN METERS, UNLESS OTHERWISE STATED.
4. ALL CHAINAGES ARE IN KILOMETERS.
5. DRAWING TO BE PRINTED IN COLOUR.
6. ALL LEVELS ARE IN METERS ABOVE ORDNANCE DATUM (MOD) UNLESS OTHERWISE STATED.
7. THE DART+ COASTAL NORTH PROJECT IS POSITIONED ACCORDING TO THE IRISH TRANSVERSE MERCATOR (ITM) COORDINATE SYSTEM.
8. EXISTING TROUHING TO BE REMOVED POST CONSTRUCTION OF PROPOSED TROUHING.
9. SELECTED INFRASTRUCTURE INTERVENTIONS DRIVING THE LINESIDE CIVILS DESIGN SUCH AS SUBSTATIONS HAVE BEEN SHOWN FOR INFORMATION ON THESE LINEAR WORKS PLANS. FOR A FULL PICTURE OF ALL INTERVENTIONS ACROSS THE PROJECT, PLEASE REFER TO THE BOOK 1 RAILWAY WORKS PLANS.
10. OHLE STRUCTURES ARE SHOWN AT INDICATIVE LOCATIONS AT A SPACING OF TYPICALLY 40m TO 50m. OHLE WIRES WILL SPAN BETWEEN THE STRUCTURES.

LEGEND

- DEVELOPMENT BOUNDARY
- EXISTING ELEMENTS
- ELEMENTS TO BE REMOVED
- PROPOSED UNDER TRACK CROSSING (UTX)
- PROPOSED TROUHING
- PROPOSED ELEVATED TROUHING
- PROPOSED FENCING
- CABLE DUCTS IN PLATFORM
- PROPOSED OVERHEAD LINE EQUIPMENT
- TRACKWORK (EXISTING AND PROPOSED)
- PLATFORM MODIFICATIONS
- PROPOSED SIGNAL
- PROPOSED LOCATION CASE

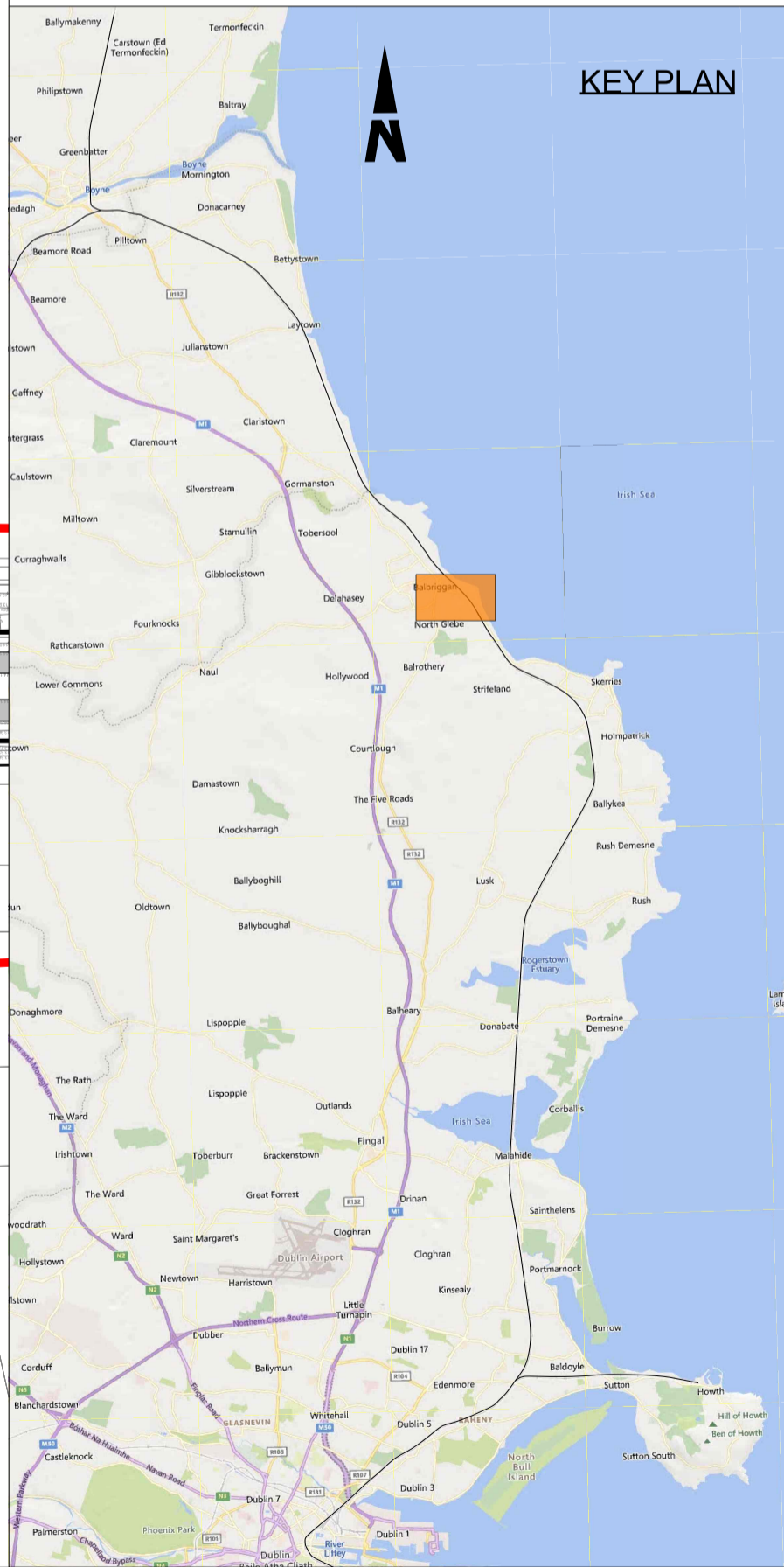

Scale : 1:500  
Paper size: 1261mm x 594mm

Disclaimer  
© Irish Rail (2023). This drawing is confidential and the copyright in it is owned by Irish Rail. This drawing must not be either loaned, copied or otherwise reproduced in whole or in part or used for any purpose without the prior permission of Irish Rail.  
© OpenStreetMap contributors  
© Ordnance Survey Ireland and Government of Ireland. All O.S. data used for plans are printed under Copyright Ordnance Survey Ireland 0039723 (OSi Aerial Data or OSi Lidar Data) & 2023 OSi, NMA, 180 (OSi Vector Data). All elevations are in metres and relate to OSi Geoid Height (OSGM02). Main Heat is defined by existing Project Control. All Co-ordinates are in Irish Transverse Mercator Grid (ITM) as defined by OSi active GPS station Tallaght College (TLTG).



Rev	Date	Dm	Chk'd	App'd	Description
P01	12/04/2024	AC	EJ	DB	PLANNING ISSUE



Date	Scale	Drawn	Checked	Approved
01/06/2023	As shown	AC	EJ	DB
Project Code	Originator Code	OMS Code	280275-00	
D+WP56	ARP			

Project Title	Drawing Title	Drawing File Name	Sheet Number	Status	Rev
DART+ COASTAL NORTH	LINEAR WORKS	D+WP56-ARP-P4-NL-DR-RO-100034	34 of 58	S3	P01

DO NOT SCALE USE FIGURED DIMENSIONS ONLY

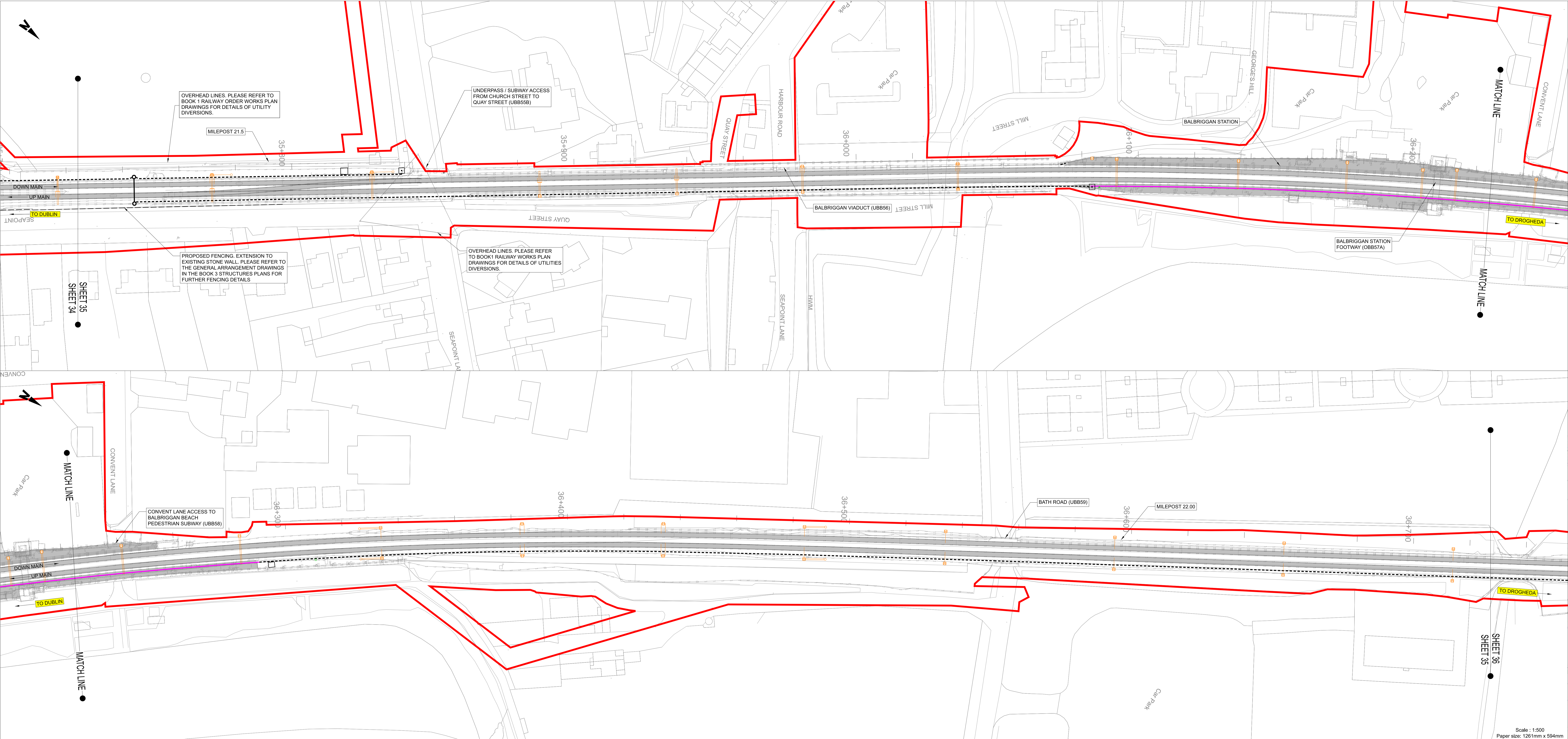

NOTES

- 1. DO NOT SCALE FROM THIS DRAWING.
- 2. THIS DRAWING SHALL BE READ IN CONJUNCTION WITH THE OTHER DRAWINGS INCLUDED IN THIS SERIES.
- 3. LOCATION OF ALL BURIED SERVICES TO BE CONFIRMED PRIOR TO CONSTRUCTION.
- 3. ALL DIMENSIONS ARE IN METERS, UNLESS OTHERWISE STATED.
- 4. ALL CHAINAGES ARE IN KILOMETERS.
- 5. DRAWING TO BE PRINTED IN COLOUR.
- 6. ALL LEVELS ARE IN METERS ABOVE ORDNANCE DATUM (MOD) UNLESS OTHERWISE STATED.
- 7. THE DART+ COASTAL NORTH PROJECT IS POSITIONED ACCORDING TO THE IRISH TRANSVERSE MERCATOR (ITM) COORDINATE SYSTEM.
- 8. EXISTING TROUGHING TO BE REMOVED POST CONSTRUCTION OF PROPOSED TROUGHING.
- 9. SELECTED INFRASTRUCTURE INTERVENTIONS DRIVING THE LINESIDE CIVILS DESIGN SUCH AS SUBSTATIONS HAVE BEEN SHOWN FOR INFORMATION ON THESE LINEAR WORKS PLANS. FOR A FULL PICTURE OF ALL INTERVENTIONS ACROSS THE PROJECT, PLEASE REFER TO THE BOOK 1 RAILWAY WORKS PLANS.
- 10. OHLE STRUCTURES ARE SHOWN AT INDICATIVE LOCATIONS AT A SPACING OF TYPICALLY 40m TO 50m. OHLE WIRES WILL SPAN BETWEEN THE STRUCTURES.

LEGEND

- DEVELOPMENT BOUNDARY
- EXISTING ELEMENTS
- ELEMENTS TO BE REMOVED
- PROPOSED UNDER TRACK CROSSING (UTX)
- - - PROPOSED TROUGHING
- - - PROPOSED ELEVATED TROUGHING
- - - PROPOSED FENCING
- CABLE DUCTS IN PLATFORM
- PROPOSED OVERHEAD LINE EQUIPMENT
- TRACKWORK (EXISTING AND PROPOSED)
- ▨ PLATFORM MODIFICATIONS
- ⊕ PROPOSED SIGNAL
- PROPOSED LOCATION CASE

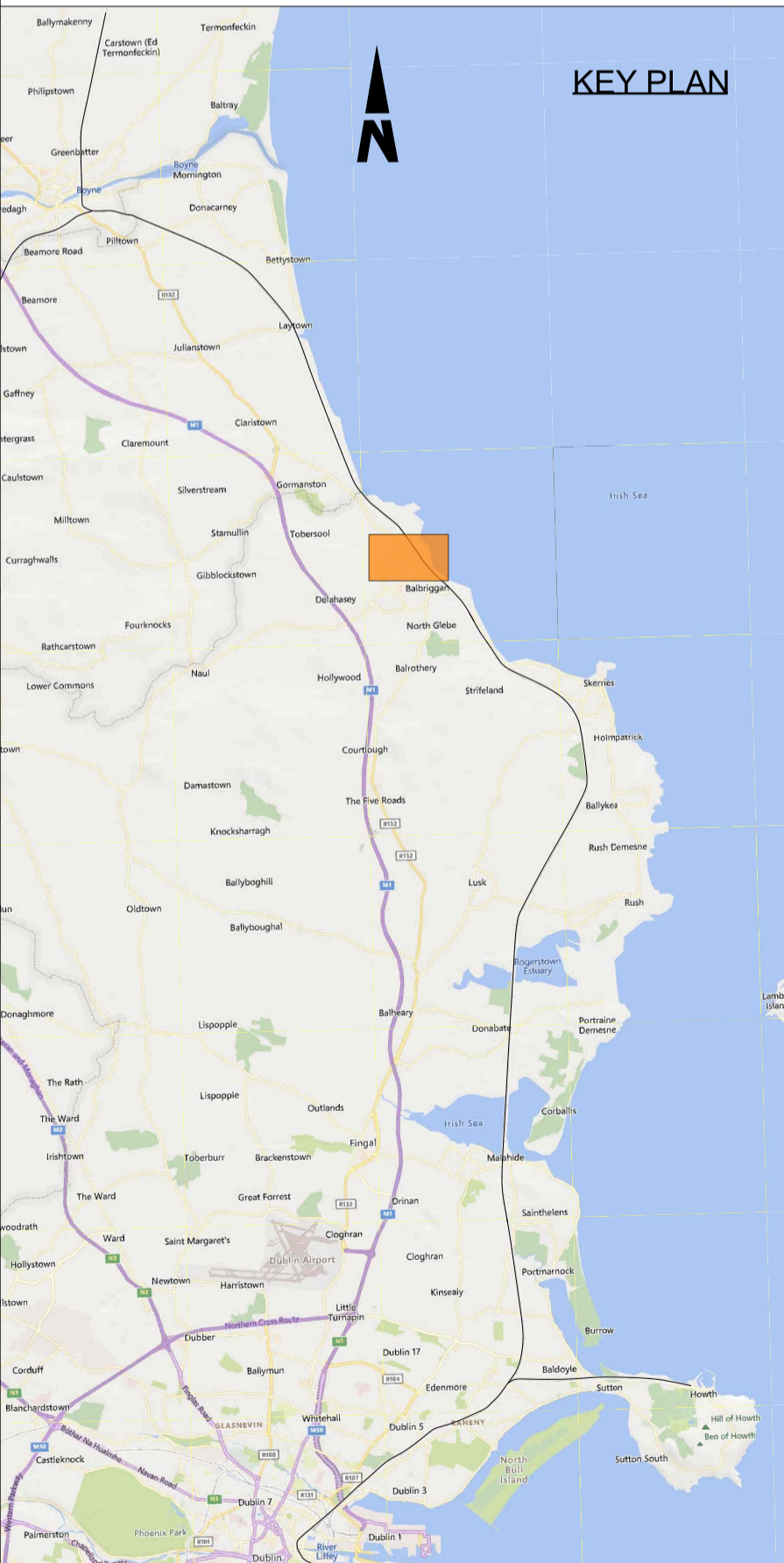

Disclaimer

© Irish Rail (2023). This drawing is confidential and the copyright in it is owned by Irish Rail. This drawing must not be either loaned, copied or otherwise reproduced in whole or in part or used for any purpose without the prior permission of Irish Rail.

© OpenStreetMap contributors

© Ordnance Survey Ireland and Government of Ireland. All O.S. data used for plans are printed under Copyright Ordnance Survey Ireland 0039723 (OSi Aerial Data or OSi Lidar Data) & 2023 OSi, NMA, 180 (OSi Vector Data). All elevations are in metres and relate to OSi Geoid Height (OSGM02). Main Head is defined by existing Project Control. All Co-ordinates are in Irish Transverse Mercator Grid (ITM) as defined by OSi active GPS station Tallaght College (TLTG).

Rev	Date	Dm	Chk'd	App'd	Description
P01	12/04/2024	AC	EJ	DB	PLANNING ISSUE

Client

Engineering Designer

Date	Scale	Drawn	Checked	Approved
01/06/2023	As shown	AC	EJ	DB

Project Code

D+WP56

Originator Code

ARP

OMS Code

280275-00

Project Title

DART+ COASTAL NORTH

Drawing Title

LINEAR WORKS

Drawing File Name

D+WP56-ARP-P4-NL-DR-RO-100035

Sheet Number

35 of 58

Status

S3

Rev

P01

Scale : 1:500  
Paper size: 1261mm x 594mm

DO NOT SCALE USE FIGURED DIMENSIONS ONLY

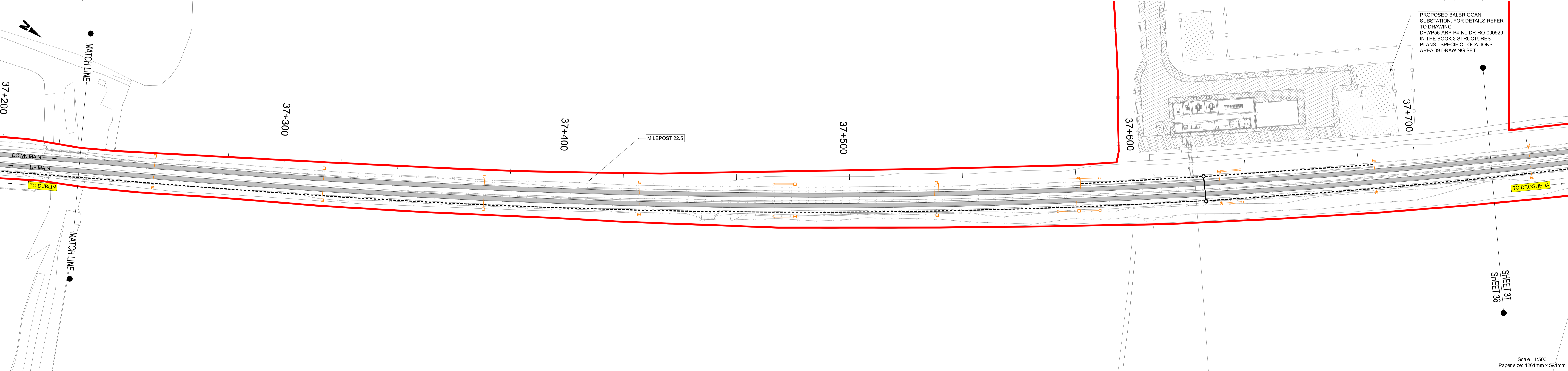
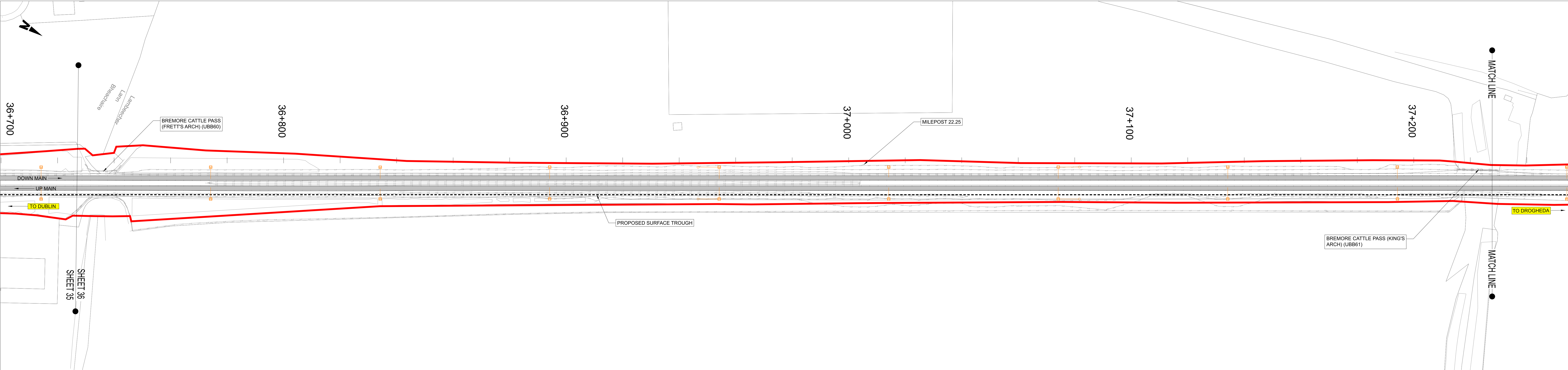

- NOTES
1. DO NOT SCALE FROM THIS DRAWING.
  2. THIS DRAWING SHALL BE READ IN CONJUNCTION WITH THE OTHER DRAWINGS INCLUDED IN THIS SERIES.
  3. LOCATION OF ALL BURIED SERVICES TO BE CONFIRMED PRIOR TO CONSTRUCTION.
  3. ALL DIMENSIONS ARE IN METERS, UNLESS OTHERWISE STATED.
  4. ALL CHAINAGES ARE IN KILOMETERS.
  5. DRAWING TO BE PRINTED IN COLOUR.
  6. ALL LEVELS ARE IN METERS ABOVE ORDNANCE DATUM (MOD) UNLESS OTHERWISE STATED.
  7. THE DART+ COASTAL NORTH PROJECT IS POSITIONED ACCORDING TO THE IRISH TRANSVERSE MERCATOR (ITM) COORDINATE SYSTEM.
  8. EXISTING TROUGHING TO BE REMOVED POST CONSTRUCTION OF PROPOSED TROUGHING.
  9. SELECTED INFRASTRUCTURE INTERVENTIONS DRIVING THE LINESIDE CIVILS DESIGN SUCH AS SUBSTATIONS HAVE BEEN SHOWN FOR INFORMATION ON THESE LINEAR WORKS PLANS. FOR A FULL PICTURE OF ALL INTERVENTIONS ACROSS THE PROJECT, PLEASE REFER TO THE BOOK 1 RAILWAY WORKS PLANS.
  10. OHLE STRUCTURES ARE SHOWN AT INDICATIVE LOCATIONS AT A SPACING OF TYPICALLY 40m TO 50m. OHLE WIRES WILL SPAN BETWEEN THE STRUCTURES.

- LEGEND
- DEVELOPMENT BOUNDARY
  - EXISTING ELEMENTS
  - ELEMENTS TO BE REMOVED
  - PROPOSED UNDER TRACK CROSSING (UTX)
  - - - PROPOSED TROUGHING
  - - - PROPOSED ELEVATED TROUGHING
  - - - PROPOSED FENCING
  - CABLE DUCTS IN PLATFORM
  - PROPOSED OVERHEAD LINE EQUIPMENT
  - TRACKWORK (EXISTING AND PROPOSED)
  - ▨ PLATFORM MODIFICATIONS
  - ⊕ PROPOSED SIGNAL
  - PROPOSED LOCATION CASE

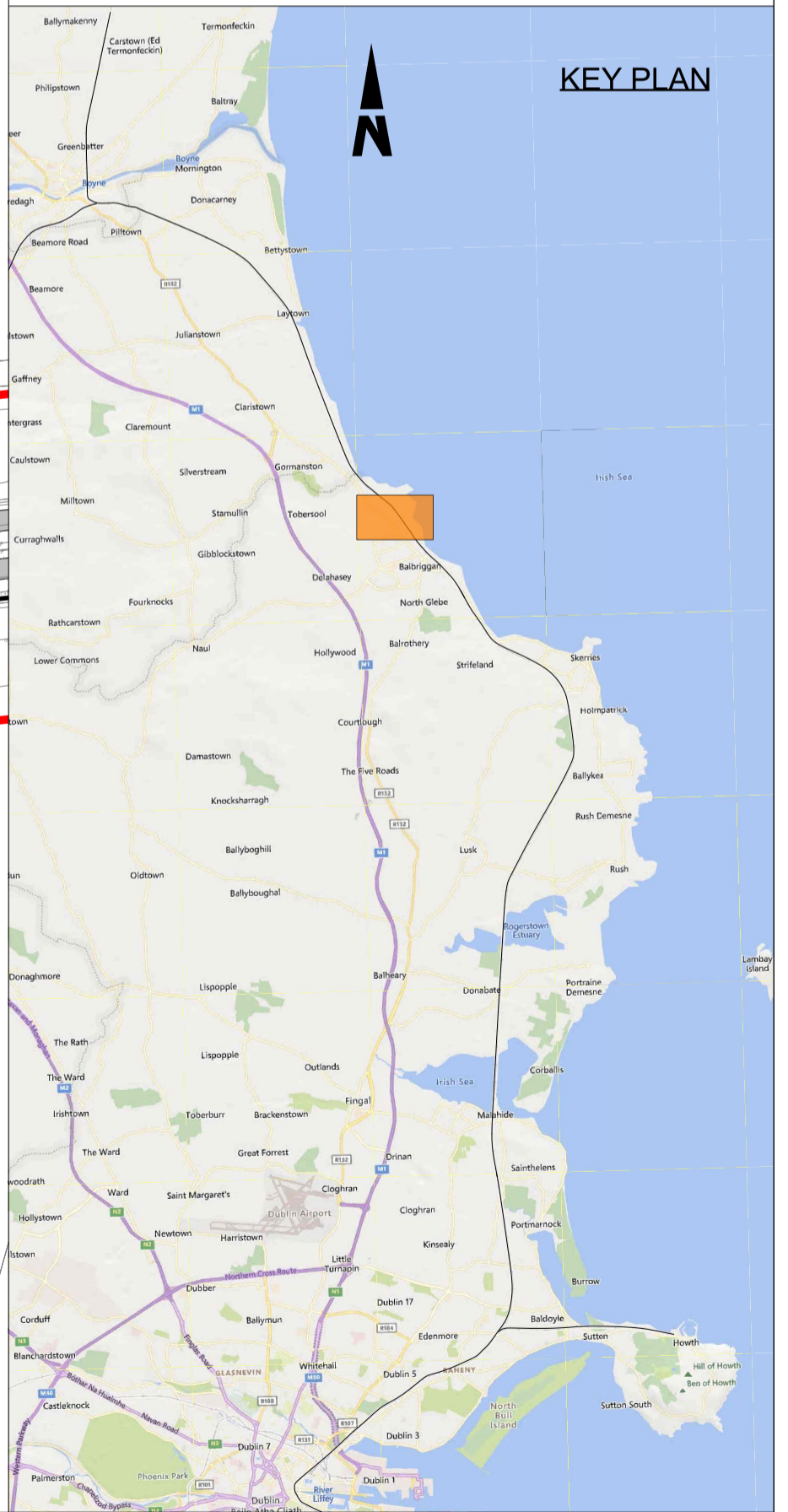

<div>Disclaimer</div> <div><div><div><div><div><div></div></div><div><div></div></div></div><div><div></div></div><div><div></div></div></div><div><div></div></div><div><div></div></div></div><div><div></div></div><div><div></div></div></div> <div><div></div></div> <div><div></div></div> <div><div></div></div> <div><div></div></div> <div><div></div></div> <div><div></div></div> <div><div></div></div> <div><div></div></div> <div><div></div></div> <div><div></div></div> <div><div></div></div> <div><div></div></div> <div><div></div></div> <div><div></div></div> <div><div></div></div> <div><div></div></div> <div><div></div></div> <div><div></div></div> <div><div></div></div> <div><div></div></div> <div><div></div></div> <div><div></div></div> <div><div></div></div> <div><div></div></div> <div><div></div></div> <div><div></div></div> <div><div></div></div> <div><div></div></div> <div><div></div></div> <div><div></div></div> <div><div></div></div> <div><div></div></div> <div><div></div></div> <div><div></div></div> <div><div></div></div> <div><div></div></div> <div><div></div></div> <div><div></div></div> <div><div></div></div> <div><div></div></div> <div><div></div></div> <div><div></div></div> <div><div></div></div> <div><div></div></div> <div><div></div></div> <div><div></div></div> <div><div></div></div> <div><div></div></div> <div><div></div></div> <div><div></div></div> <div><div></div></div> <div><div></div></div> <div><div></div></div> <div><div></div></div> <div><div></div></div> <div><div></div></div> <div><div></div></div> <div><div></div></div> <div><div></div></div> <div><div></div></div> <div><div></div></div> <div><div></div></div> <div><div></div></div> <div><div></div></div> <div><div></div></div> <div><div></div></div> <div><div></div></div> <div><div></div></div> <div><div></div></div> <div><div></div></div> <div><div></div></div> <div><div></div></div> <div><div></div></div> <div><div></div></div> <div><div></div></div> <div><div></div></div> <div><div></div></div> <div><div></div></div> <div><div></div></div> <div><div></div></div> <div><div></div></div> <div><div></div></div> <div><div></div></div> <div><div></div></div> <div><div></div></div> <div><div></div></div> <div><div></div></div> <div><div></div></div> <div><div></div></div> <div><div></div></div> <div><div></div></div> <div><div></div></div> <div><div></div></div> <div><div></div></div> <div><div></div></div> <div><div></div></div> <div><div></div></div> <div><div></div></div> <div><div></div></div> <div><div></div></div> <div><div></div></div> <div><div></div></div> <div><div></div></div> <div><div></div></div> <div><div></div></div> <div><div></div></div> <div><div></div></div> <div><div></div></div> <div><div></div></div> <div><div></div></div> <div><div></div></div> <div><div></div></div> <div><div></div></div> <div><div></div></div> <div><div></div></div> <div><div></div></div> <div><div></div></div> <div><div></div></div> <div><div></div></div> <div><div></div></div> <div><div></div></div> <div><div></div></div> <div><div></div></div> <div><div></div></div> <div><div></div></div> <div><div></div></div> <div><div></div></div> <div><div></div></div> <div><div></div></div> <div><div></div></div> <div><div></div></div> <div><div></div></div> <div><div></div></div> <div><div></div></div> <div><div></div></div> <div><div></div></div> <div><div></div></div> <div><div></div></div> <div><div></div></div> <div><div></div></div> <div><div></div></div> <div><div></div></div> <div><div></div></div> <div><div></div></div> <div><div></div></div> <div><div></div></div> <div><div></div></div> <div><div></div></div> <div><div></div></div> <div><div></div></div> <div><div></div></div> <div><div></div></div> <div><div></div></div> <div><div></div></div> <div><div></div></div> <div><div></div></div> <div><div></div></div> <div><div></div></div> <div><div></div></div> <div><div></div></div> <div><div></div></div> <div><div></div></div> <div><div></div></div> <div><div></div></div> <div><div></div></div> <div><div></div></div> <div><div></div></div> <div><div></div></div> <div><div></div></div> <div><div></div></div> <div><div></div></div> <div><div></div></div> <div><div></div></div> <div><div></div></div> <div><div></div></div> <div><div></div></div> <div><div></div></div> <div><div></div></div> <div><div></div></div> <div><div></div></div> <div><div></div></div> <div><div></div></div> <div><div></div></div> <div><div></div></div> <div><div></div></div> <div><div></div></div> <div><div></div></div> <div><div></div></div> <div><div></div></div> <div><div></div></div> <div><div></div></div> <div><div></div></div> <div><div></div></div> <div><div></div></div> <div><div></div></div> <div><div></div></div> <div><div></div></div> <div><div></div></div> <div><div></div></div> <div><div></div></div> <div><div></div></div> <div><div></div></div> <div><div></div></div> <div><div></div></div> <div><div></div></div> <div><div></div></div> <div><div></div></div> <div><div></div></div> <div><div></div></div> <div><div></div></div> <div><div></div></div> <div><div></div></div> <div><div></div></div> <div><div></div></div> <div><div></div></div> <div><div></div></div> <div><div></div></div> <div><div></div></div> <div><div></div></div> <div><div></div></div> <div><div></div></div> <div><div></div></div> <div><div></div></div> <div><div></div></div> <div><div></div></div> <div><div></div></div> <div><div></div></div> <div><div></div></div> <div><div></div></div> <div><div></div></div> <div><div></div></div> <div><div></div></div> <div><div></div></div> <div><div></div></div> <div><div></div></div> <div><div></div></div> <div><div></div></div> <div><div></div></div> <div><div></div></div> <div><div></div></div> <div><div></div></div> <div><div></div></div> <div><div></div></div> <div><div></div></div> <div><div></div></div> <div><div></div></div> <div><div></div></div> <div><div></div></div> <div><div></div></div> <div><div></div></div> <div><div></div></div> <div><div></div></div> <div><div></div></div> <div><div></div></div> <div><div></div></div> <div><div></div></div> <div><div></div></div> <div><div></div></div> <div><div></div></div> <div><div></div></div> <div><div></div></div> <div><div></div></div> <div><div></div></div> <div><div></div></div> <div><div></div></div> <div><div></div></div> <div><div></div></div> <div><div></div></div> <div><div></div></div> <div><div></div></div> <div><div></div></div> <div><div></div></div> <div><div></div></div> <div><div></div></div> <div><div></div></div> <div><div></div></div> <div><div></div></div> <div><div></div></div> <div><div></div></div> <div><div></div></div> <div><div></div></div> <div><div></div></div> <div><div></div></div> <div><div></div></div> <div><div></div></div> <div><div></div></div> <div><div></div></div> <div><div></div></div> <div><div></div></div> <div><div></div></div> <div><div></div></div> <div><div></div></div> <div><div></div></div> <div><div></div></div> <div><div></div></div> <div><div></div></div> <div><div></div></div> <div><div></div></div> <div><div></div></div> <div><div></div></div> <div><div></div></div> <div><div></div></div> <div><div></div></div> <div><div></div></div> <div><div></div></div> <div><div></div></div> <div><div></div></div> <div><div></div></div> <div><div></div></div> <div><div></div></div> <div><div></div></div> <div><div></div></div> <div><div></div></div> <div><div></div></div> <div><div></div></div> <div><div></div></div> <div><div></div></div> <div><div></div></div> <div><div></div></div> <div><div></div></div> <div><div></div></div> <div><div></div></div> <div><div></div></div> <div><div></div></div> <div><div></div></div> <div><div></div></div> <div><div></div></div> <div><div></div></div> <div><div></div></div> <div><div></div></div> <div><div></div></div> <div><div></div></div> <div><div></div></div> <div><div></div></div> <div><div></div></div> <div><div></div></div> <div><div></div></div> <div><div></div></div> <div><div></div></div> <div><div></div></div> <div><div></div></div> <div><div></div></div> <div><div></div></div> <div><div></div></div> <div><div></div></div> <div><div></div></div> <div><div></div></div> <div><div></div></div> <div><div></div></div> <div><div></div></div> <div><div></div></div> <div><div></div></div> <div><div></div></div> <div><div></div></div> <div><div></div></div> <div><div></div></div> <div><div></div></div> <div><div></div></div> <div><div></div></div> <div><div></div></div> <div><div></div></div> <div><div></div></div> <div><div></div></div> <div><div></div></div> <div><div></div></div> <div><div></div></div> <div><div></div></div> <div><div></div></div> <div><div></div></div> <div><div></div></div> <div><div></div></div> <div><div></div></div> <div><div></div></div> <div><div></div></div> <div><div></div></div> <div><div></div></div> <div><div></div></div> <div><div></div></div> <div><div></div></div> <div><div></div></div> <div><div></div></div> <div><div></div></div> <div><div></div></div> <div><div></div></div> <div><div></div></div> <div><div></div></div> <div><div></div></div> <div><div></div></div> <div><div></div></div> <div><div></div></div> <div><div></div></div> <div><div></div></div> <div><div></div></div> <div><div></div></div> <div><div></div></div> <div><div></div></div> <div><div></div></div> <div><div></div></div> <div><div></div></div> <div><div></div></div> <div><div></div></div> <div><div></div></div> <div><div></div></div> <div><div></div></div> <div><div></div></div> <div><div></div></div> <div><div></div></div> <div><div></div></div> <div><div></div></div> <div><div></div></div> <div><div></div></div> <div><div></div></div> <div><div></div></div> <div><div></div></div> <div><div></div></div> <div><div></div></div> <div><div></div></div> <div><div></div></div> <div><div></div></div> <div><div></div></div> <div><div></div></div> <div><div></div></div> <div><div></div></div> <div><div></div></div> <div><div></div></div> <div><div></div></div> <div><div></div></div> <div><div></div></div> <div><div></div></div> <div><div></div></div> <div><div></div></div> <div><div></div></div> <div><div></div></div> <div><div></div></div> <div><div></div></div> <div><div></div></div> <div><div></div></div> <div><div></div></div> <div><div></div></div> <div><div></div></div> <div><div></div></div> <div><div></div></div> <div><div></div></div> <div><div></div></div> <div><div></div></div> <div><div></div></div> <div><div></div></div> <div><div></div></div> <div><div></div></div> <div><div></div></div> <div><div></div></div> <div><div></div></div> <div><div></div></div> <div><div></div></div> <div><div></div></div> <div><div></div></div> <div><div></div></div> <div><div></div></div> <div><div></div></div> <div><div></div></div> <div><div></div></div> <div><div></div></div> <div><div></div></div> <div><div></div></div> <div><div></div></div> <div><div></div></div> <div><div></div></div> <div><div></div></div> <div><div></div></div> <div><div></div></div> <div><div></div></div> <div><div></div></div> <div><div></div></div> <div><div></div></div> <div><div></div></div> <div><div></div></div> <div><div></div></div> <div><div></div></div> <div><div></div></div> <div><div></div></div> <div><div></div></div> <div><div></div></div>									
--	--	--	--	--	--	--	--	--	--

DO NOT SCALE USE FIGURED DIMENSIONS ONLY

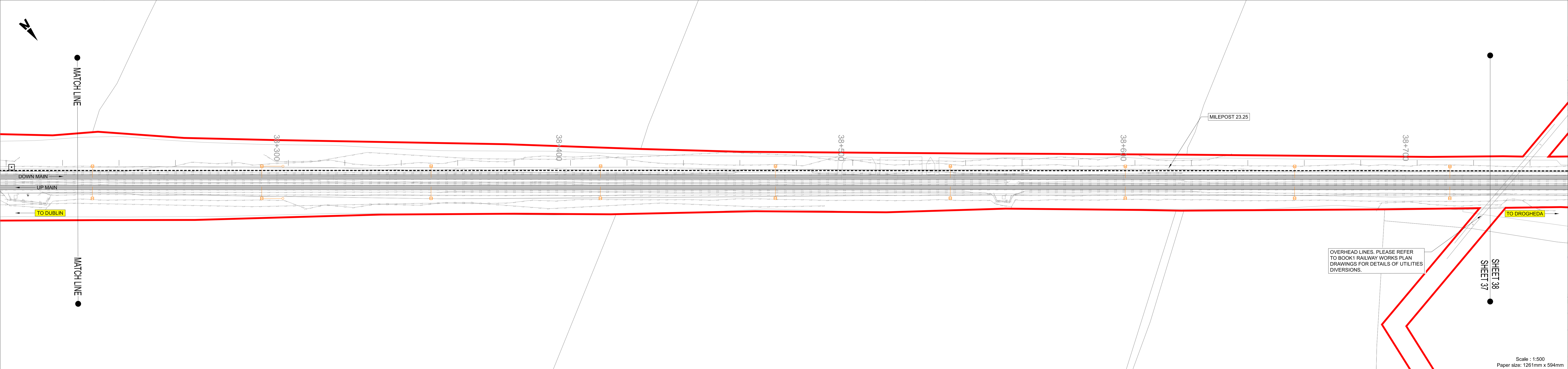
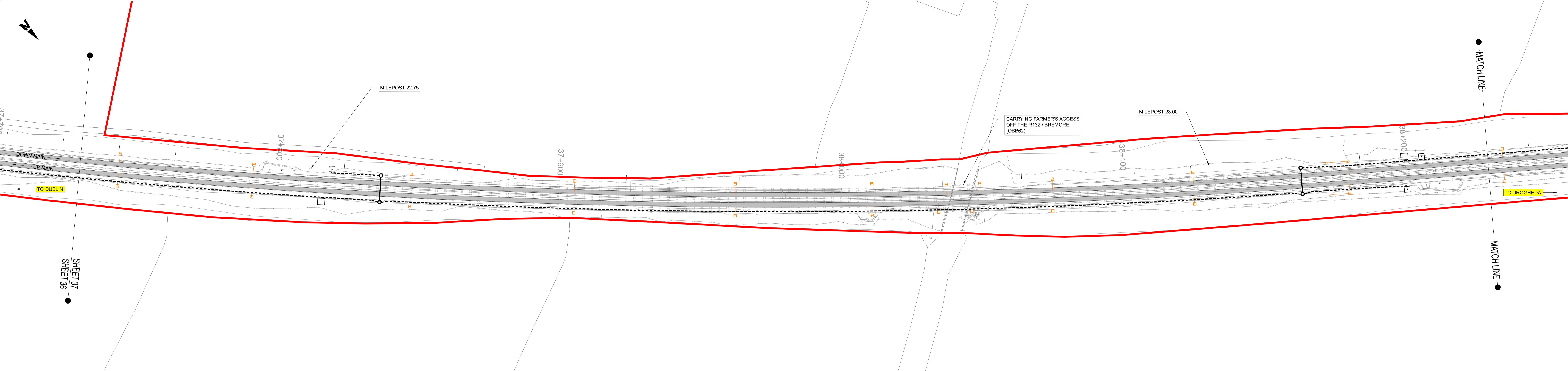

NOTES

1. DO NOT SCALE FROM THIS DRAWING.
2. THIS DRAWING SHALL BE READ IN CONJUNCTION WITH THE OTHER DRAWINGS INCLUDED IN THIS SERIES.
3. LOCATION OF ALL BURIED SERVICES TO BE CONFIRMED PRIOR TO CONSTRUCTION.
3. ALL DIMENSIONS ARE IN METERS, UNLESS OTHERWISE STATED.
4. ALL CHAINAGES ARE IN KILOMETERS.
5. DRAWING TO BE PRINTED IN COLOUR.
6. ALL LEVELS ARE IN METERS ABOVE ORDNANCE DATUM (MOD) UNLESS OTHERWISE STATED.
7. THE DART+ COASTAL NORTH PROJECT IS POSITIONED ACCORDING TO THE IRISH TRANSVERSE MERCATOR (ITM) COORDINATE SYSTEM.
8. EXISTING TROUGHING TO BE REMOVED POST CONSTRUCTION OF PROPOSED TROUGHING.
9. SELECTED INFRASTRUCTURE INTERVENTIONS DRIVING THE LINESIDE CIVILS DESIGN SUCH AS SUBSTATIONS HAVE BEEN SHOWN FOR INFORMATION ON THESE LINEAR WORKS PLANS. FOR A FULL PICTURE OF ALL INTERVENTIONS ACROSS THE PROJECT, PLEASE REFER TO THE BOOK 1 RAILWAY WORKS PLANS.
10. OHLE STRUCTURES ARE SHOWN AT INDICATIVE LOCATIONS AT A SPACING OF TYPICALLY 40m TO 50m. OHLE WIRES WILL SPAN BETWEEN THE STRUCTURES.

LEGEND

- DEVELOPMENT BOUNDARY
- EXISTING ELEMENTS
- ELEMENTS TO BE REMOVED
- PROPOSED UNDER TRACK CROSSING (UTX)
- PROPOSED TROUGHING
- PROPOSED ELEVATED TROUGHING
- PROPOSED FENCING
- CABLE DUCTS IN PLATFORM
- PROPOSED OVERHEAD LINE EQUIPMENT
- TRACKWORK (EXISTING AND PROPOSED)
- PLATFORM MODIFICATIONS
- PROPOSED SIGNAL
- PROPOSED LOCATION CASE

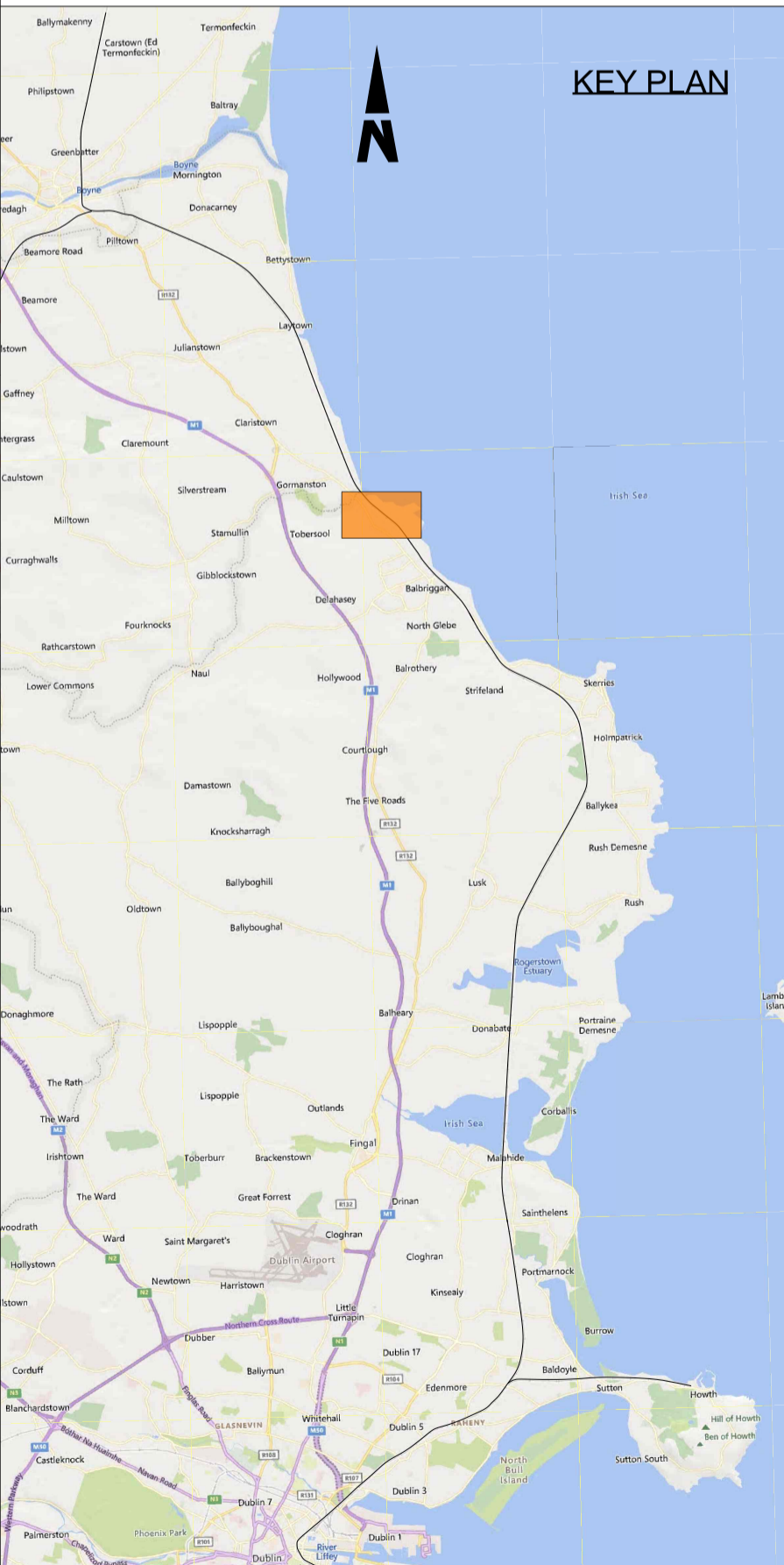

<div>Disclaimer</div> <div><div><div>© Irish Rail (2023). This drawing is confidential and the copyright in it is owned by Irish Rail. This drawing must not be either loaned, copied or otherwise reproduced in whole or in part or used for any purpose without the prior permission of Irish Rail.</div><div>© OpenStreetMap contributors</div><div>© Ordnance Survey Ireland and Government of Ireland. All O.S. data used for plans are printed under Copyright Ordnance Survey Ireland 0039723 (OSi Aerial Data or OSi Lidar Data) &amp; 2023 OSi, NMA, 180 (OSi Vector Data). All elevations are in metres and relate to OSi Geoid Model (OSGM02). Main Heat as defined by existing Project Control. All Co-ordinates are in Irish Transverse Mercator Grid (ITM) as defined by OSi active GPS station Tallaght College (TLTG).</div></div></div> <div><div><div><div><div></div><div>DART+ Coastal North</div></div><div><div>NTA</div><div>National Transport Authority</div></div><div><div>Tionscadal Éireann</div><div>Project Ireland 2040</div></div></div></div></div> <div><table><tr><th>Rev</th><th>Date</th><th>Dm</th><th>Chk'd</th><th>App'd</th><th>Description</th></tr><tr><td>P01</td><td>12/04/2024</td><td>AC</td><td>EJ</td><td>DB</td><td>PLANNING ISSUE</td></tr><tr><td> </td><td> </td><td> </td><td> </td><td> </td><td> </td></tr><tr><td> </td><td> </td><td> </td><td> </td><td> </td><td> </td></tr><tr><td> </td><td> </td><td> </td><td> </td><td> </td><td> </td></tr><tr><td> </td><td> </td><td> </td><td> </td><td> </td><td> </td></tr></table></div> <div><div><div><div><div></div><div>Iarnród Éireann</div><div>Irish Rail</div></div><div><div>Date</div><div>01/06/2023</div></div><div><div>Scale</div><div>As shown</div></div><div><div>Drawn</div><div>AC</div></div><div><div>Checked</div><div>EJ</div></div><div><div>Approved</div><div>DB</div></div></div><div><div><div>Project Code</div><div>D+WP56</div></div><div><div>Originator Code</div><div>ARP</div></div><div><div>OMS Code</div><div>280275-00</div></div></div></div><div><div>Engineering Designer</div><div><div></div><div>ARUP</div></div></div><div><div><div>Project Title</div><div>DART+ COASTAL NORTH</div></div><div><div>Drawing Title</div><div>LINEAR WORKS</div></div><div><div>Drawing File Name</div><div>D+WP56-ARP-P4-NL-DR-RO-100037</div></div><div><div>Sheet Number</div><div>37 of 58</div></div><div><div>Status</div><div>S3</div></div><div><div>Rev</div><div>P01</div></div></div></div> </										Rev	Date	Dm	Chk'd	App'd	Description	P01	12/04/2024	AC	EJ	DB	PLANNING ISSUE																								
Rev	Date	Dm	Chk'd	App'd	Description																																								
P01	12/04/2024	AC	EJ	DB	PLANNING ISSUE																																								

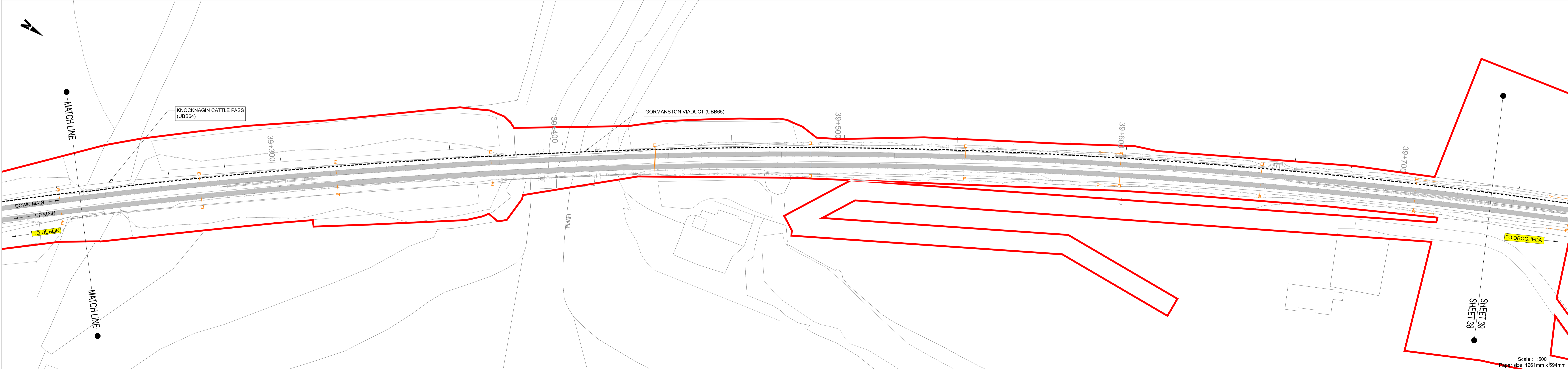
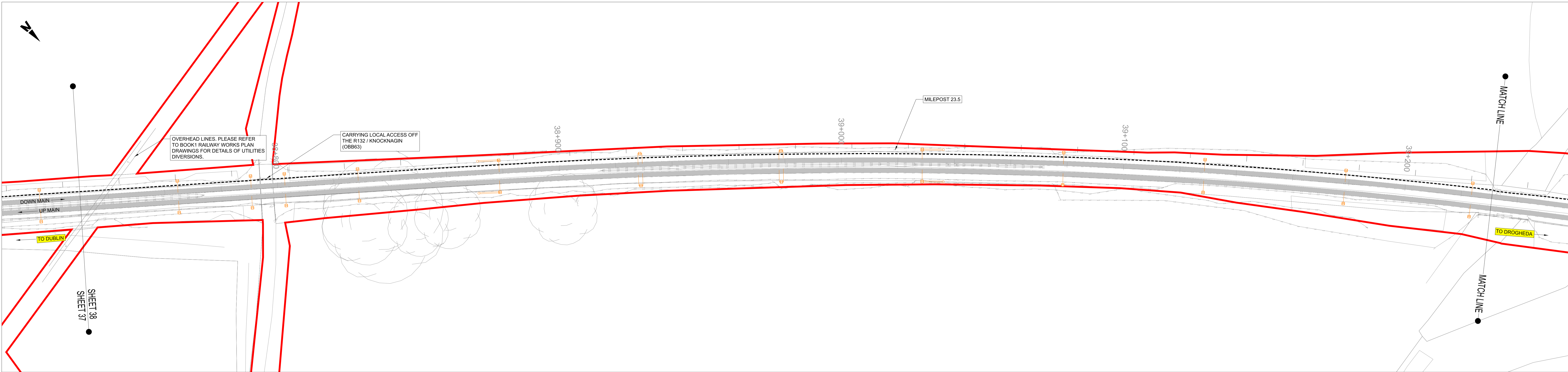

NOTES

1. DO NOT SCALE FROM THIS DRAWING.
2. THIS DRAWING SHALL BE READ IN CONJUNCTION WITH THE OTHER DRAWINGS INCLUDED IN THIS SERIES.
3. LOCATION OF ALL BURIED SERVICES TO BE CONFIRMED PRIOR TO CONSTRUCTION.
3. ALL DIMENSIONS ARE IN METERS, UNLESS OTHERWISE STATED.
4. ALL CHAINAGES ARE IN KILOMETERS.
5. DRAWING TO BE PRINTED IN COLOUR.
6. ALL LEVELS ARE IN METERS ABOVE ORDNANCE DATUM (MOD) UNLESS OTHERWISE STATED.
7. THE DART+ COASTAL NORTH PROJECT IS POSITIONED ACCORDING TO THE IRISH TRANSVERSE MERCATOR (ITM) COORDINATE SYSTEM.
8. EXISTING TROUGHING TO BE REMOVED POST CONSTRUCTION OF PROPOSED TROUGHING.
9. SELECTED INFRASTRUCTURE INTERVENTIONS DRIVING THE LINESIDE CIVILS DESIGN SUCH AS SUBSTATIONS HAVE BEEN SHOWN FOR INFORMATION ON THESE LINEAR WORKS PLANS. FOR A FULL PICTURE OF ALL INTERVENTIONS ACROSS THE PROJECT, PLEASE REFER TO THE BOOK 1 RAILWAY WORKS PLANS.
10. OHLE STRUCTURES ARE SHOWN AT INDICATIVE LOCATIONS AT A SPACING OF TYPICALLY 40m TO 50m. OHLE WIRES WILL SPAN BETWEEN THE STRUCTURES.

LEGEND

- DEVELOPMENT BOUNDARY
- EXISTING ELEMENTS
- ELEMENTS TO BE REMOVED
- PROPOSED UNDER TRACK CROSSING (UTX)
- - - PROPOSED TROUGHING
- - - PROPOSED ELEVATED TROUGHING
- - - PROPOSED FENCING
- CABLE DUCTS IN PLATFORM
- PROPOSED OVERHEAD LINE EQUIPMENT
- TRACKWORK (EXISTING AND PROPOSED)
- ▨ PLATFORM MODIFICATIONS
- ⊕ PROPOSED SIGNAL
- PROPOSED LOCATION CASE

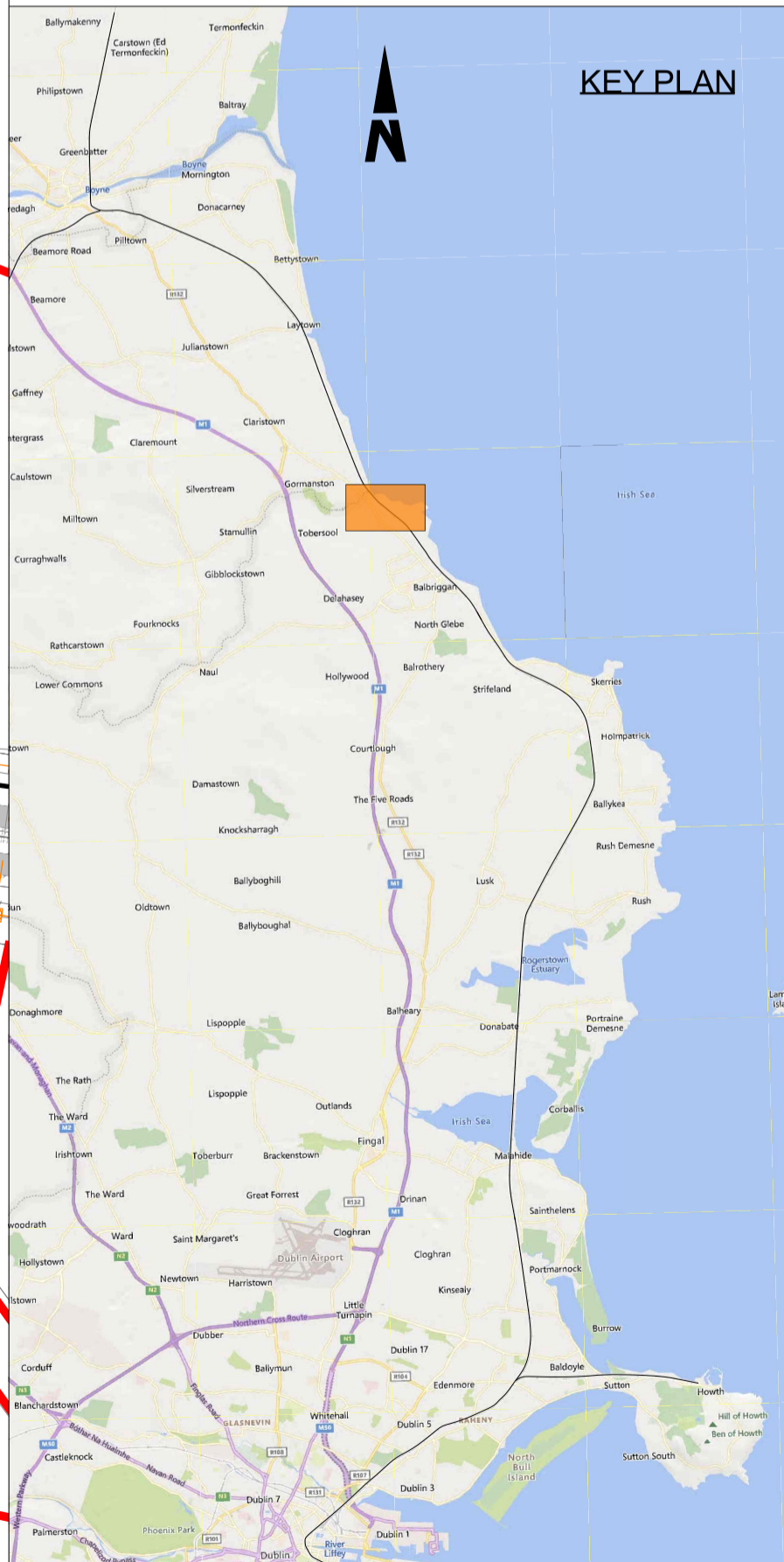

<div><div><div>Disclaimer</div><div>© Irish Rail (2023). This drawing is confidential and the copyright in it is owned by Irish Rail. This drawing must not be either loaned, copied or otherwise reproduced in whole or in part or used for any purpose without the prior permission of Irish Rail.</div><div>© OpenStreetMap contributors</div><div>© Ordnance Survey Ireland and Government of Ireland. All O.S. data used for plans are printed under Copyright Ordnance Survey Ireland 0039723 (OSi Aerial Data or OSi Lidar Data) &amp; 2023 OSi, NMA, 1st (OSi Vector Data). All elevations are in metres and relate to OSi Geoid Model (OSGM02). Main Head as defined by existing Project Control. All Co-ordinates are in Irish Transverse Mercator Grid (ITM) as defined by OSi active GPS station Tallaght College (TLTG).</div></div><div><div><div><div><div></div><div>DART+ Coastal North</div></div><div><div>NTA</div><div>National Transport Authority</div></div><div><div><div></div><div>Tionacdal Éireann</div><div>Project Ireland 2040</div></div></div></div></div></div><div><table><tr><th>Rev</th><th>Date</th><th>Dm</th><th>Chk'd</th><th>App'd</th><th>Description</th></tr><tr><td>P01</td><td>12/04/2024</td><td>AC</td><td>EJ</td><td>DB</td><td>PLANNING ISSUE</td></tr><tr><td> </td><td> </td><td> </td><td> </td><td> </td><td> </td></tr><tr><td> </td><td> </td><td> </td><td> </td><td> </td><td> </td></tr><tr><td> </td><td> </td><td> </td><td> </td><td> </td><td> </td></tr></table></div></div> <div><div><div><div><div></div><div>Iarnród Éireann</div><div>Irish Rail</div></div><div><div></div><div>ARUP</div></div></div><div><table><tr><th>Date</th><th>Scale</th><th>As shown</th></tr><tr><td>18/07/2023</td><td>As shown</td><td></td></tr></table></div><div><table><tr><th>Project Code</th><th>Originator Code</th><th>OMS Code</th></tr><tr><td>D+WP56</td><td>ARP</td><td>280275-00</td></tr></table></div></div><div><div><div>Engineering Designer</div><div><div></div><div>Project Title</div><div>DART+ COASTAL NORTH</div></div><div><div></div><div>Drawing Title</div><div>LINEAR WORKS</div></div></div><div><table><tr><th>Drawing File Name</th><th>Sheet Number</th><th>Status</th><th>Rev</th></tr><tr><td>D+WP56-ARP-P4-NL-DR-RO-100038</td><td>38 of 58</td><td>S3</td><td>P01</td></tr></table></div></div></div>										Rev	Date	Dm	Chk'd	App'd	Description	P01	12/04/2024	AC	EJ	DB	PLANNING ISSUE																			Date	Scale	As shown	18/07/2023	As shown		Project Code	Originator Code	OMS Code	D+WP56	ARP	280275-00	Drawing File Name	Sheet Number	Status	Rev	D+WP56-ARP-P4-NL-DR-RO-100038	38 of 58	S3	P01
Rev	Date	Dm	Chk'd	App'd	Description																																																						
P01	12/04/2024	AC	EJ	DB	PLANNING ISSUE																																																						
Date	Scale	As shown																																																									
18/07/2023	As shown																																																										
Project Code	Originator Code	OMS Code																																																									
D+WP56	ARP	280275-00																																																									
Drawing File Name	Sheet Number	Status	Rev																																																								
D+WP56-ARP-P4-NL-DR-RO-100038	38 of 58	S3	P01																																																								

DO NOT SCALE USE FIGURED DIMENSIONS ONLY